

Revisions:

OWNER / DEVELOPER:  
**RED LINK MANAGEMENT  
CORP**  
2750 NE 185TH ST. #304  
AVENTURA, FLORIDA 33180

PROJECT:  
**FOLIO 4942-03-27-0012  
PROPOSED SHELL BLDG @  
2100 WEST ATLANTIC BLDG**  
2100 W ATLANTIC BLVD  
POMPANO BEACH, FLORIDA 33069

Job Number: 24109.01

File name:

Issued Date: 05-14-2025

Drawn by: A.S

Checked by: T.R.

SHEET NAME

**ROOF PLAN  
BUILDING  
2**

SHEET NUMBER

**A-1.1**

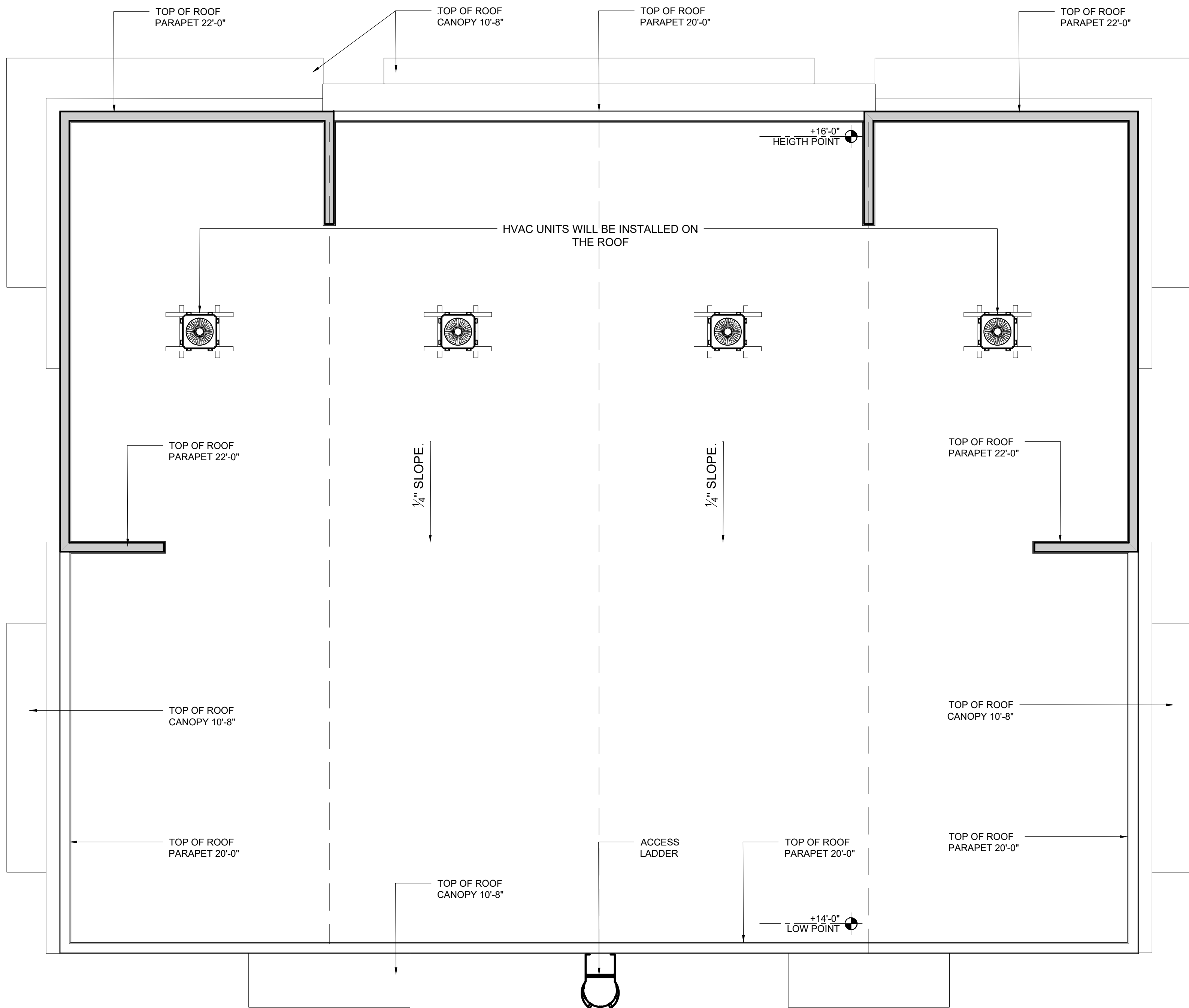

ROOF PLAN BUILDING 2

SCALE: 1/8" = 1'-0"

NOTES

- ROOFTOP EQUIPMENT SHALL BE SCREENED FROM VIEW BY PARAPET, MASONRY WALL OR OTHER ARCHITECTURAL FEATURES OF THE BUILDING. SUCH ENCLOSURES SHALL BE AS HIGH OR HIGHER THAT THE HIGHEST PORTION OF THE EQUIPMENT OR APPARATUS BEING SCREENED.
- SUCH AS AIR CONDITION/ HEATING UNITS AND STATIONARY EMERGENCY GENERATORS SHALL BE ENCLOSED BY WALL, SOLID FENCE, HEDGE OR OTHER DEVICES THAT WILL EFFECTIVELY SCREEN SUCH EQUIPMENT FROM PUBLIC VIEW.